

24" OVERLAY READY REFRIGERATOR DRAWERS

TUR-24-D-OP-C

FEATURES

- Environmentally friendly, R600a hydrocarbon refrigerant that improves performance and efficiency while ensuring quiet operation.
- Industry exclusive, 300-series stainless steel interior.*
- Patented TruLumina® LED lighting gently illuminates your product and allows you to choose from 14 different color options with the push of a button.
- True Precision Control® with steel touch technology and readout provides digital accuracy.
- Balanced, forced-air refrigeration system enables rapid product pull down and even temperature throughout.
- Exclusive True®-Glide soft-close feature for both drawers.
- Rated for both beverage and open food storage.
- NSF/ANSI Standard 7 compliant for packaged food product.
- Sabbath mode compliant.
- All undercounter models UL rated for outdoor use.

ORGANIZATION

- 2 heavy-duty adjustable bin dividers per drawer.

BUILD YOUR TRUE

Customize your True with a variety of finish and hardware options at true-residential.com.

CUSTOMIZATION

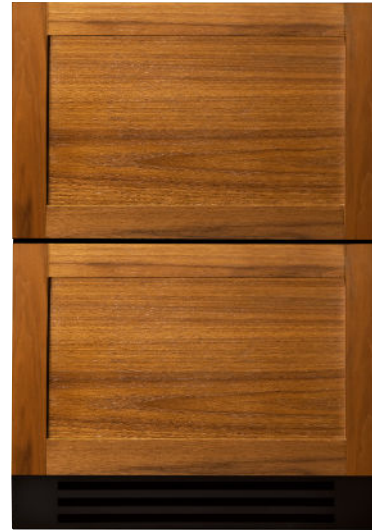

SPECIFICATIONS

Dimensions* (w x h x d) 23⁷/₈" x 34¹/₄" x 23⁷/₈"

Cutout Dimensions (w x h x d) 24" x 34¹/₂" x 24"

Standard Overlay Panel (w x h x d) 23⁵/₈" x 14¹¹/₁₆" x ³/₄"

Panel provided by others. Other installation options available.
Consult install guide for details.

Capacity (cu. ft.) 5.4  x 207

Temperature Range 33°F - 47°F

Weight (lbs.) 210

Voltage 115/60/1  115/60/1 NEMA-5-15R

Amps 1.9

Annual Energy Consumption (kwh) 277

Power Cord Length (ft.) 8

Energy Star Rated Yes

*NOTE: Overlay models have black powder coated steel exteriors.

*Dimensions may vary +/- 1/8"

24" OVERLAY READY REFRIGERATOR DRAWERS

TUR-24-D-OP-C – (shown with a 3/4" cabinetry panel)

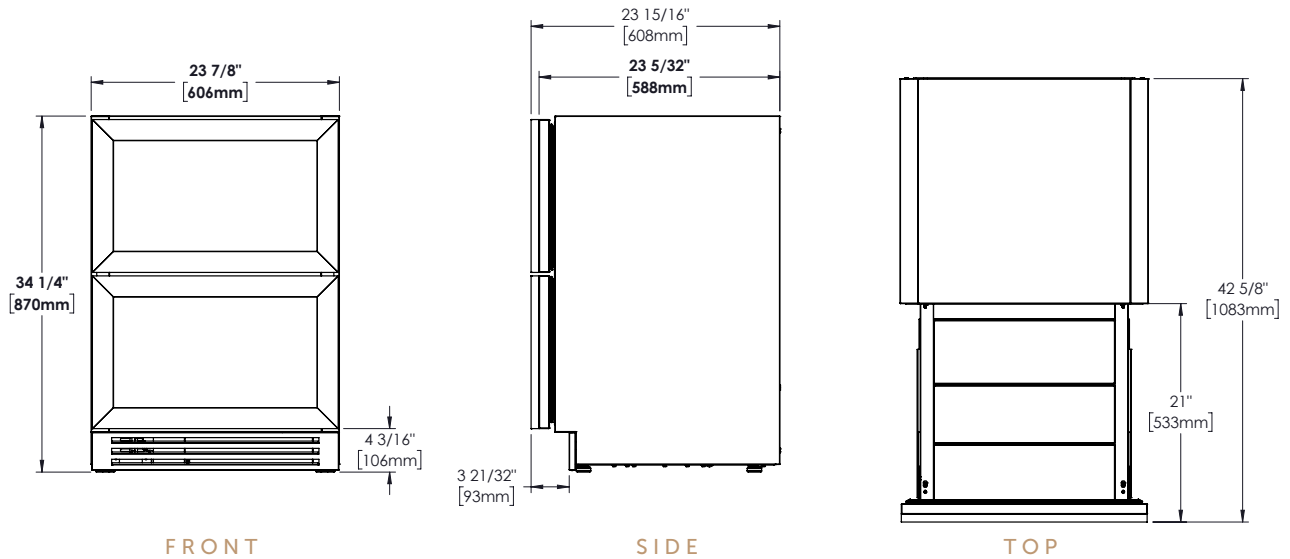

OPENING DIMENSIONS



MODEL OPTIONS

MODEL	FINISH
TUR-24-D-OP-C	Overlay Panel Refrigerator Drawer

ACCESSORIES (OPTIONAL)

- Anti-condensation pads
- Drawer pan kit

WARRANTY

- 3 year full (parts & labor)
- 6 year sealed system (parts & labor)
- 7-12 year (parts only – sealed system on registered products)

